

# 2F

## Floor Plan

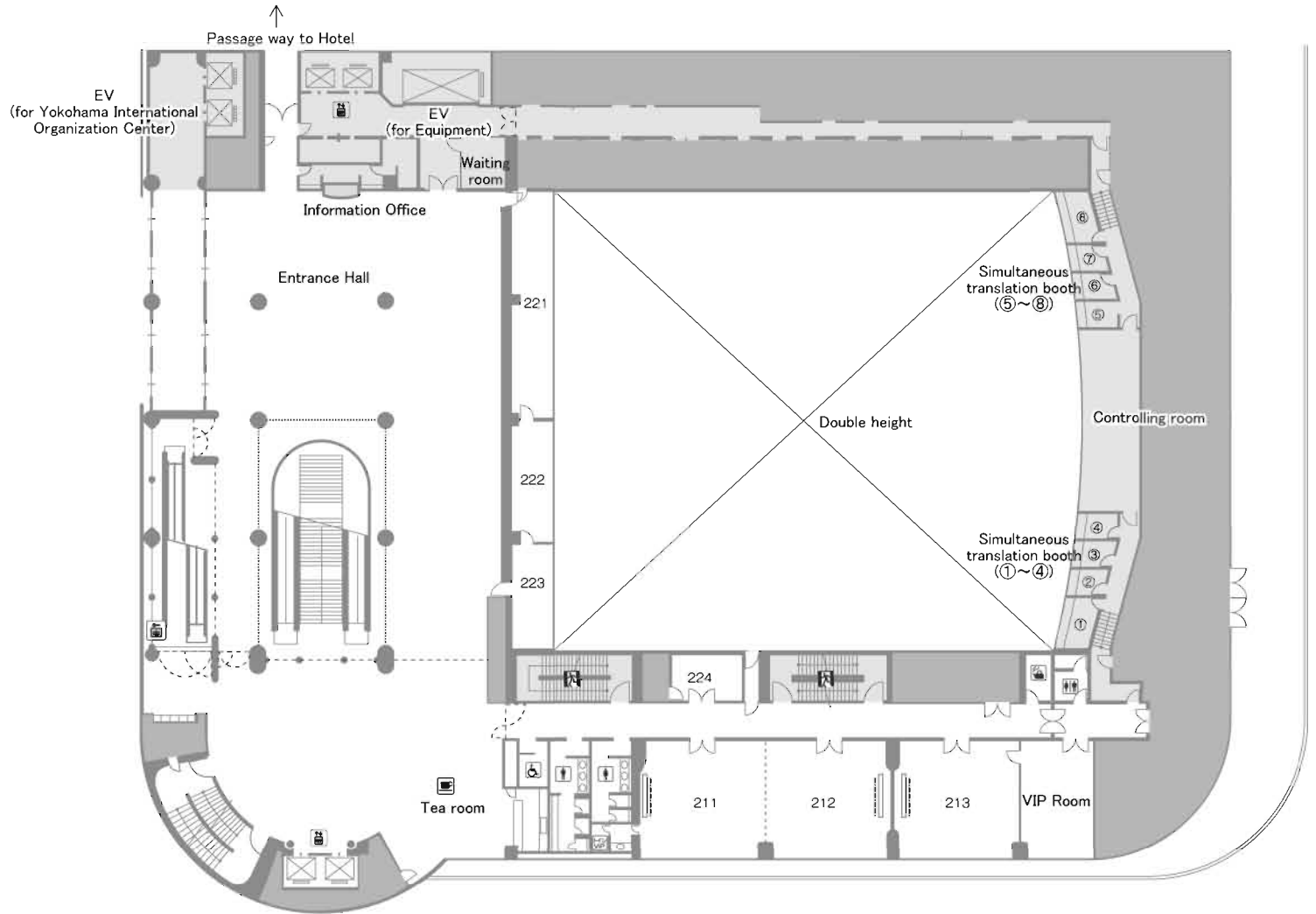

- Toilet ( for wheelchair)
- Toilet (for men)
- Toilet (for women)
- Smoking area
- Staff kitchen
- Equipment for baby
- Equipment for ostomate
- First Aid room
- AED
- Food place
- Public phone
- Elevator
- Emergency Exit
- Stage
- Screen
- Coin locker